



**CONDENSED
PROFILE**

ATLANTIC & CENTRAL

REGION

FROM

HALIFAX

TO

STE. ROSALIE JCT.

ON SLOW

MILE 2.50

No. 2.0 NORTH RIVER 2-T.P.G. 90:0" (D.T.)
B/R to Ground 16:0"

TRURO
DIVISIONAL YARD
WATER & COAL

MILE 0.00

No. 0.7 BIBLE HILL ROAD UNDER-X.
E.B. 4'-20" IS. 18:10" B/R to Ground 15:0"
W.B. 2'- " " " " " " " " " " " "
No. 0.6 " SALMON RIVER
E.B. 2'-D.P.G. 105" B/R to Ground 23:0"
W.B. 2'- " " " " " " " " " " " "

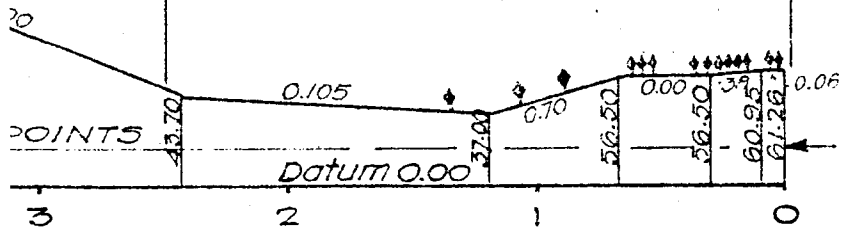

MILEAGE



TRURO
DIVISIONAL YD.
COAL WATER

MILE 64.02

Begin Double Track
Mi. 63.83.
Mi. 63.56 Set with D.A.R.
Mi. 63.51 H.B. Yd. 5d9.

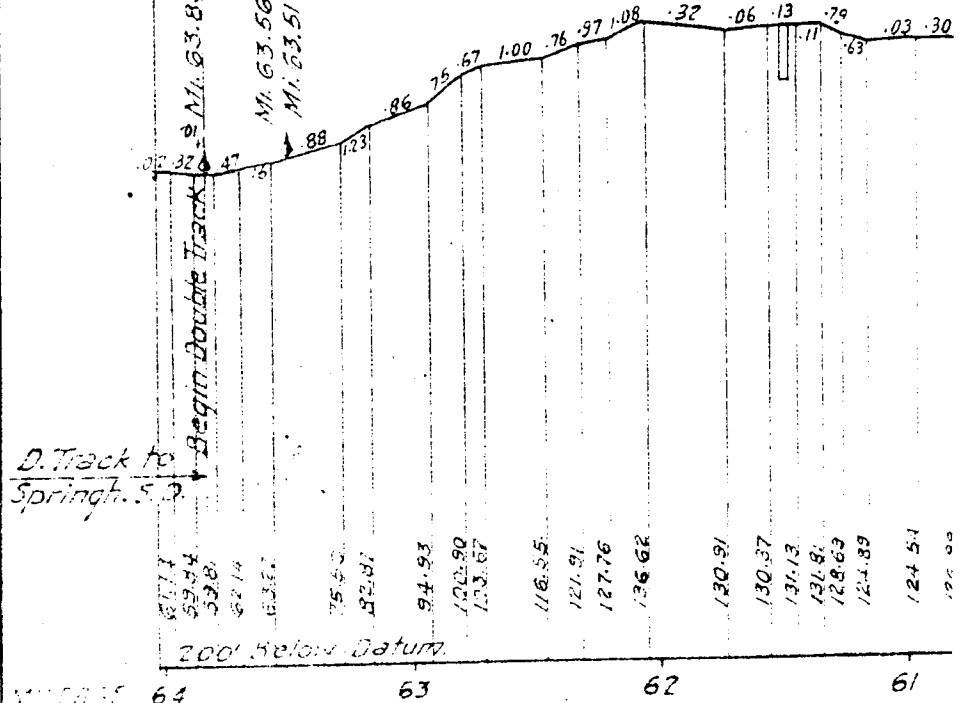

MILEAGE

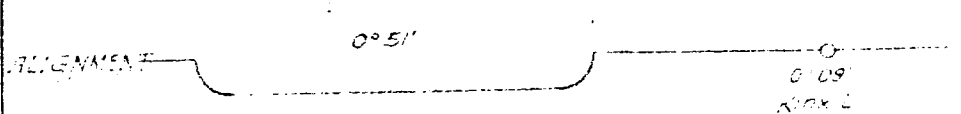

No. 61.5- McCLURE BROOK
D.P.G. 84:2" x 30'

HILDEN

BROOKFIELD

BRENTWOOD

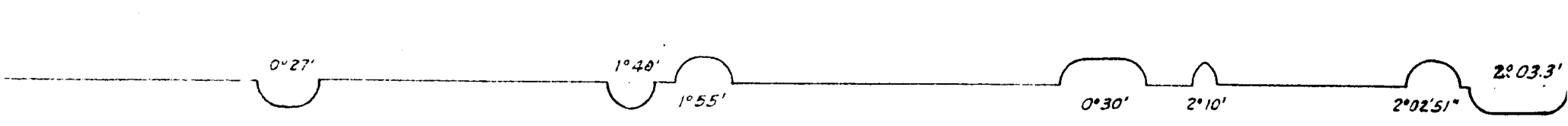
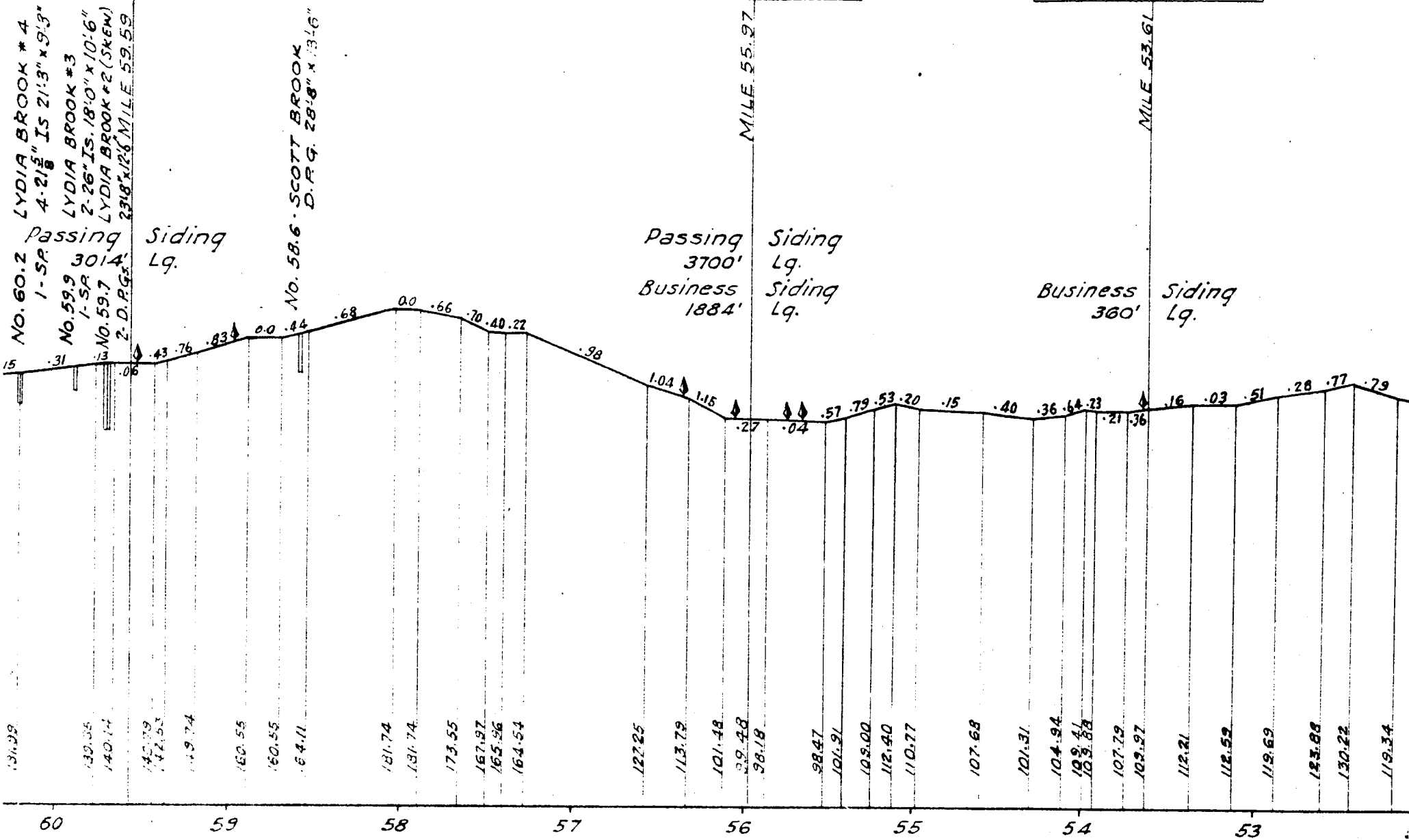

NO. 60.2 LYDIA BROOK #4
 1-SR 4-21 1/2" IS 21-3" x 9-3"
 NO. 59.9 LYDIA BROOK #3
 1-SR 2-26" IS. 18'0" x 10'6"
 NO. 59.7 LYDIA BROOK #2 (SKW)
 2-D.R.G. 23'8" x 12'6" M.I.E. 59.59

Passing Siding
 3014' Lq.

No. 58.6 - SCOTT BROOK
 D.R.G. 28'8" x 13'6"

Passing Business
 3700' 1884'

Siding Siding
 Lq. Lq.

Business Siding
 360' Lq.

MILE 55.97

MILE 53.61

ALTON
WATER

MCKAY

STEWIACKE

MILE 51.19

MILE 49.27

MILE 46.66

Passing 3035'
Siding Lg.

Business 534'
Siding Lg.

Passing 3168'
Business 1076'
Private Siding 861' Lg.
J. Lewis & Son

NO. 487 STEWIACKE RIVER
1-D.R.G. 91'0", 1-D.R.G. 101'8" Height 32'

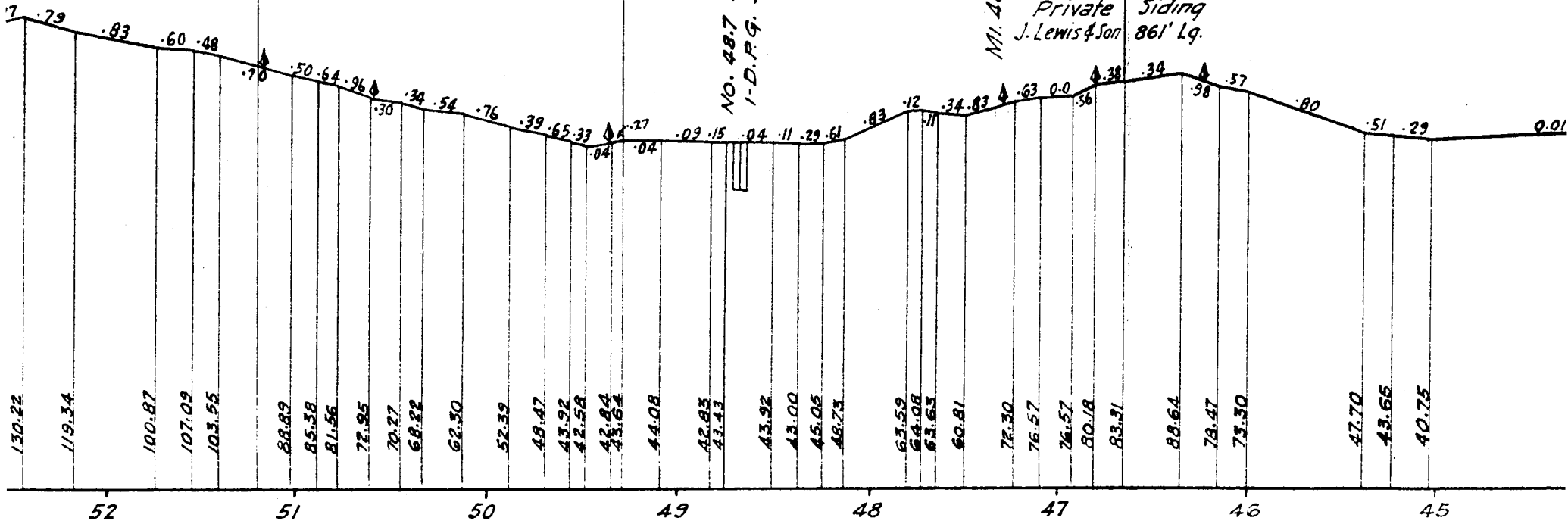

2° 03.3'

2° 43'

2° 10'

2° 04' 2° 14'

0° 28.6'

0° 21.6'

0.32.5'

MILLER

SHUBENACADIE

DEWIS

MILFORD

MILE 43.72

MILE 40.51

MILE 38.44

SHUBENACADIE RIVER
1-D.P.G. 102'8", 2-D.P.G.S. 104' HI. 40'
SHUBENACADIE RD. UNDER-X.
1-D. P.G. 25'6" B/R TO G. 18'9"
MILE 42.17

No. 40.1 McDERMID ROAD
1-Sp. 2.26" Is 17'0" x 15'

Passing Siding
3331' Lq.
2-Business Sidings
2792' Lq.
Private Siding
St. George Con. Co. 347' Lq.

Passing Siding
3000' Lq.
Business Siding
1002' Lq.
2-Private Sidings
1172' Lq.

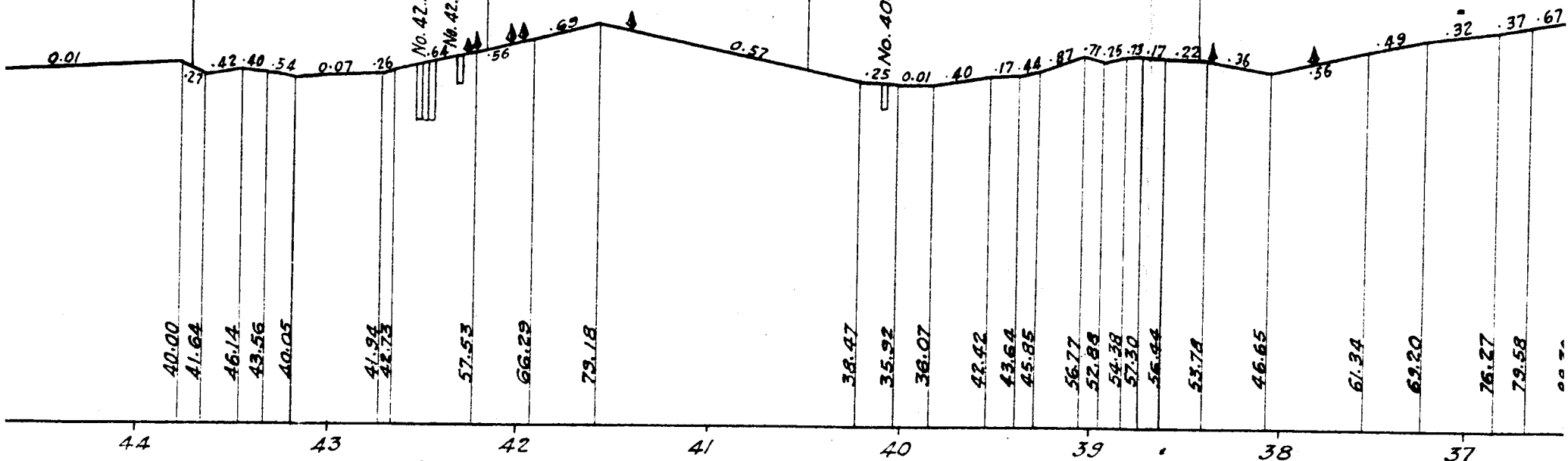

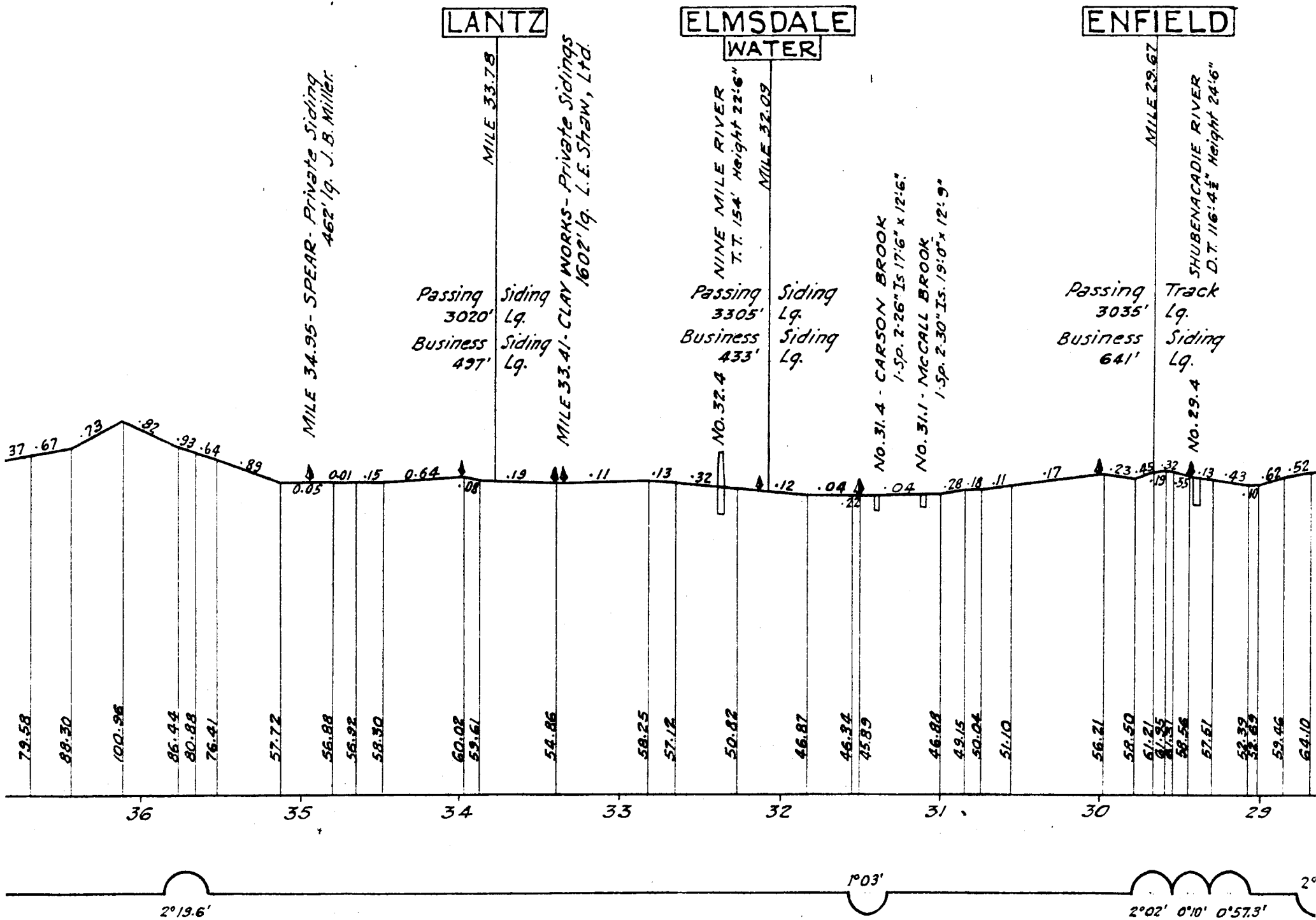

D

INDUSTRIAL RIVER
D.T. 116:4 1/2" Height 24'6"
ck
ling

SANDY COVE

FLETCHER

KING

OAKFIELD

GRAND LAKE

WELLINGTON

MILE 27.45

MILE 27.00

MILE 26.25

MILE 25.03

MILE 23.37

MILE 22.59

Passing Track
2943'

Track Lg.

Business Siding Lg.
325'

Siding Lg.

Passing Siding
3555'

Siding Lg.

No. 22.4 - WELLINGTON CANAL.
2-D.P.Gs. 34:6", 1-D.P.G. 54:0" Ht. 31:3"

No. 21.5 - RAWDON RIVER.
3-D.P.Gs. 28:0" Ht. 13:0"

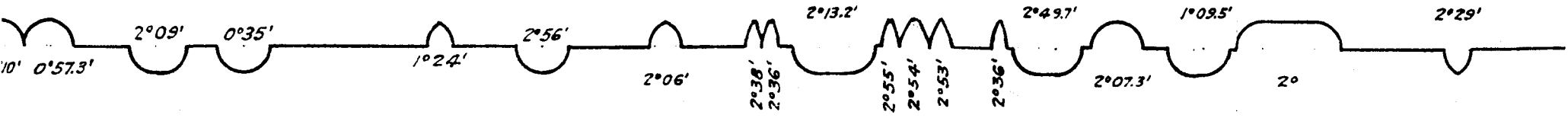
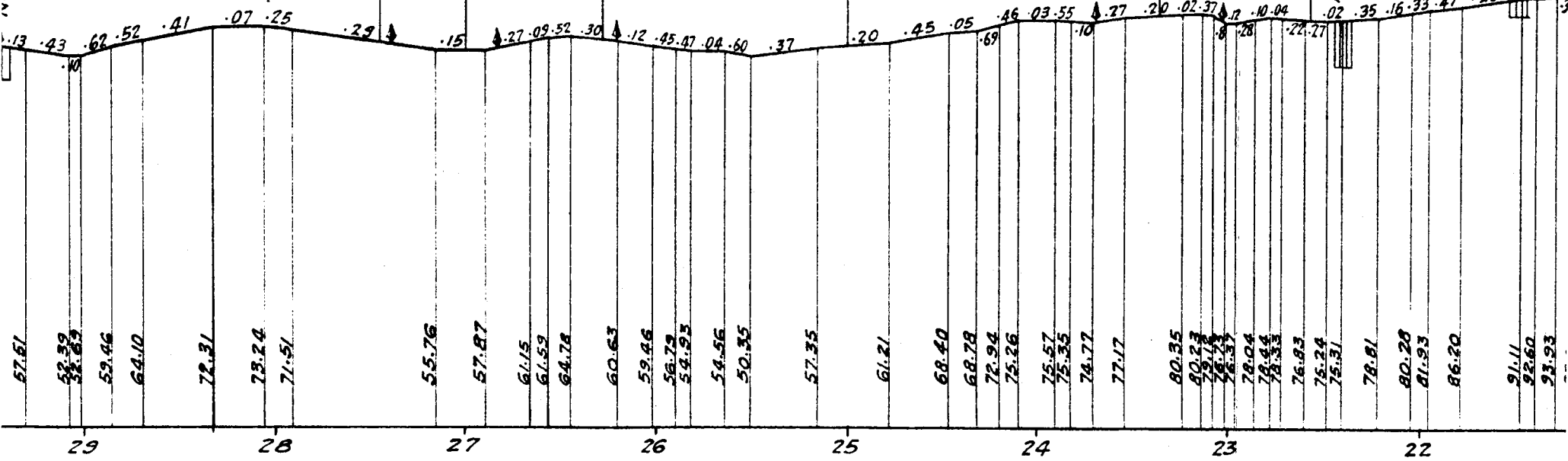

No. 21.5 - RAWDON RIVER.
3-D.R.Gs. 28'0" H. 13'0"

KINSAC

BEAVER RIVER
2-5p. 4-218" Is., 2-3p. 4-24" Is. H.H. 9'
MILE 20.02

Passing 3026'
Business 568'
Siding Lg.
Siding Lg.

No. 20.2

FALL RIVER

WINDSOR JCT.

COBEQUID RD.

LAKE VIEW

WATER

WYE ON Junction
Dartmouth D.A.R.
with Subdiv'n.

H.B. Mi. 16.72

Nor. H.B. Wye.
Mi. 15.91 H.B. Jct. SW.

Sou. H.B. Wye.

MILE 17.25

MILE 15.83

MILE 15.09

MILE 14.26

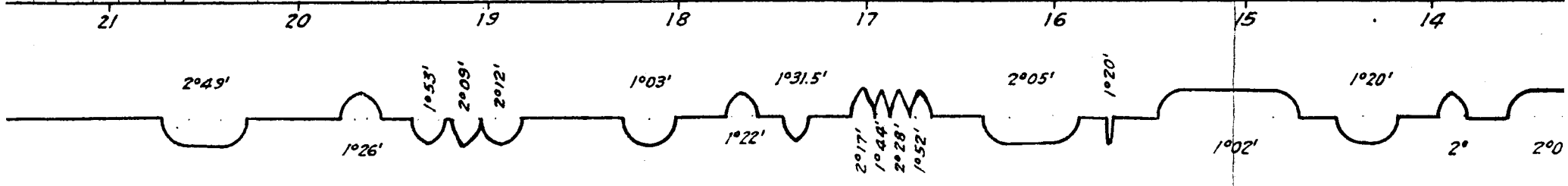
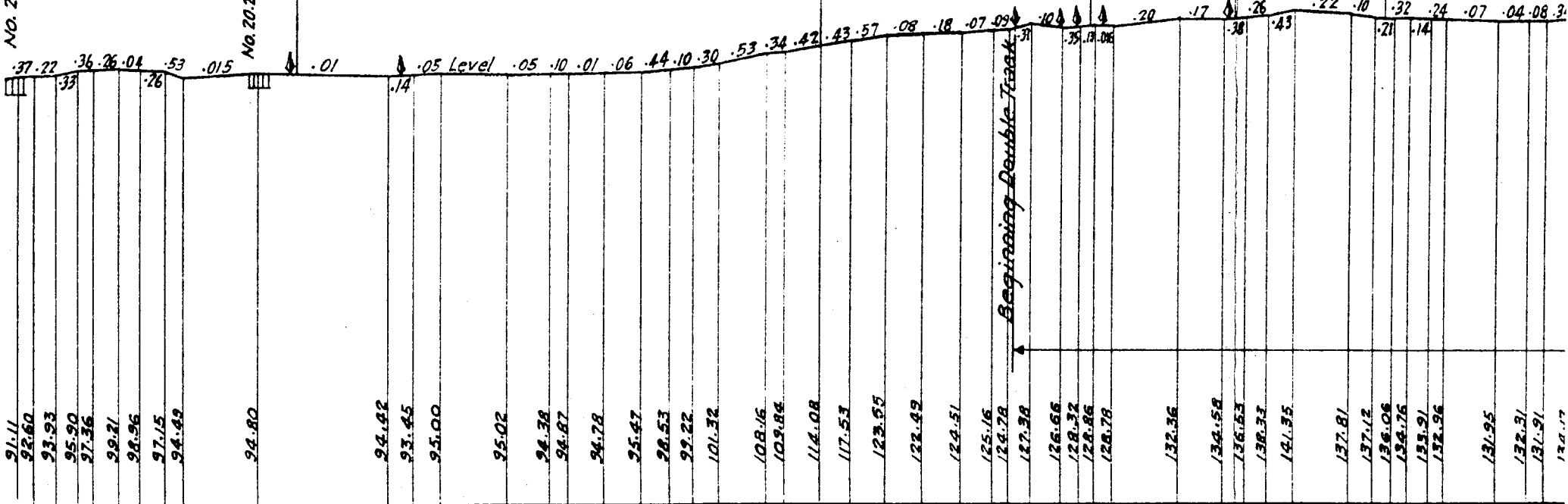

N

No. 12.7 - ROCKY LAKE OVERCROSSING.
1-T.L.G. 106'0" - 22'-6" C/889'

ISLE VIEW

BIRCH COVE

F

BEDFORD

MILL VIEW

PRINCES LODGE

ROCKINGHA

DARTMOUTH RD. UNDERCROSS'G.
1 } 2-26" IS. 18'0" HI 25'
3 } SACKVILLE RIVER.
3 } D.P.Gs. 90'2" HI 49'3"
MILE 10.56
Business Siding Lq.
395'

MILE 9.62 - MOIR - Private Siding 805' Lq.

Business Siding Lq.
557'
Private Siding Lq.
688'

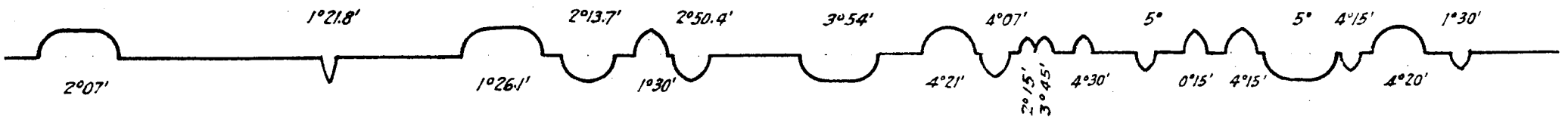
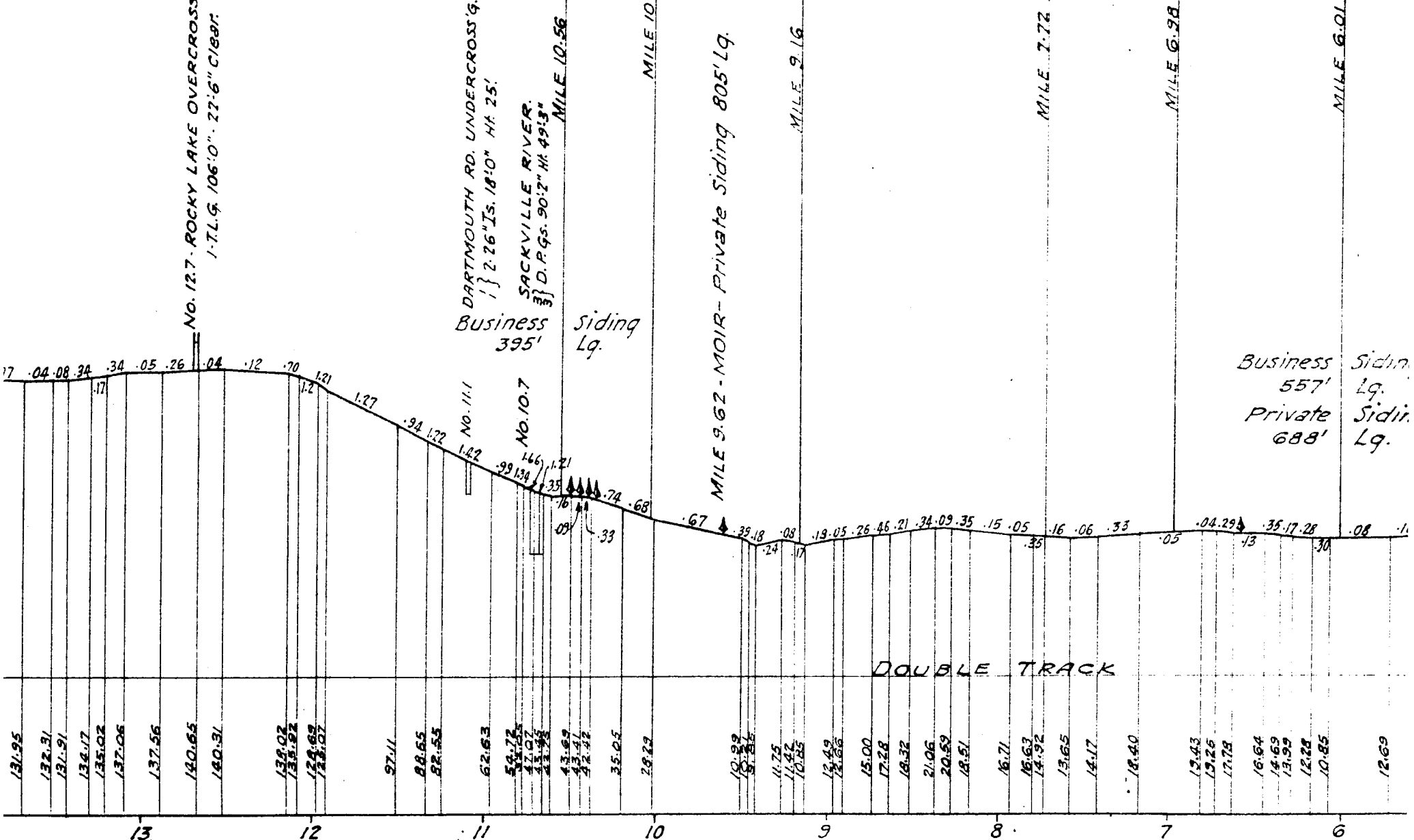

FAIRVIEW JCT.

HAM

SOUTHWESTERN J.

ARMDALE

HALIFAX

TERMINAL WATER 0.0
YARD COAL

Siding
7.
Siding
9.

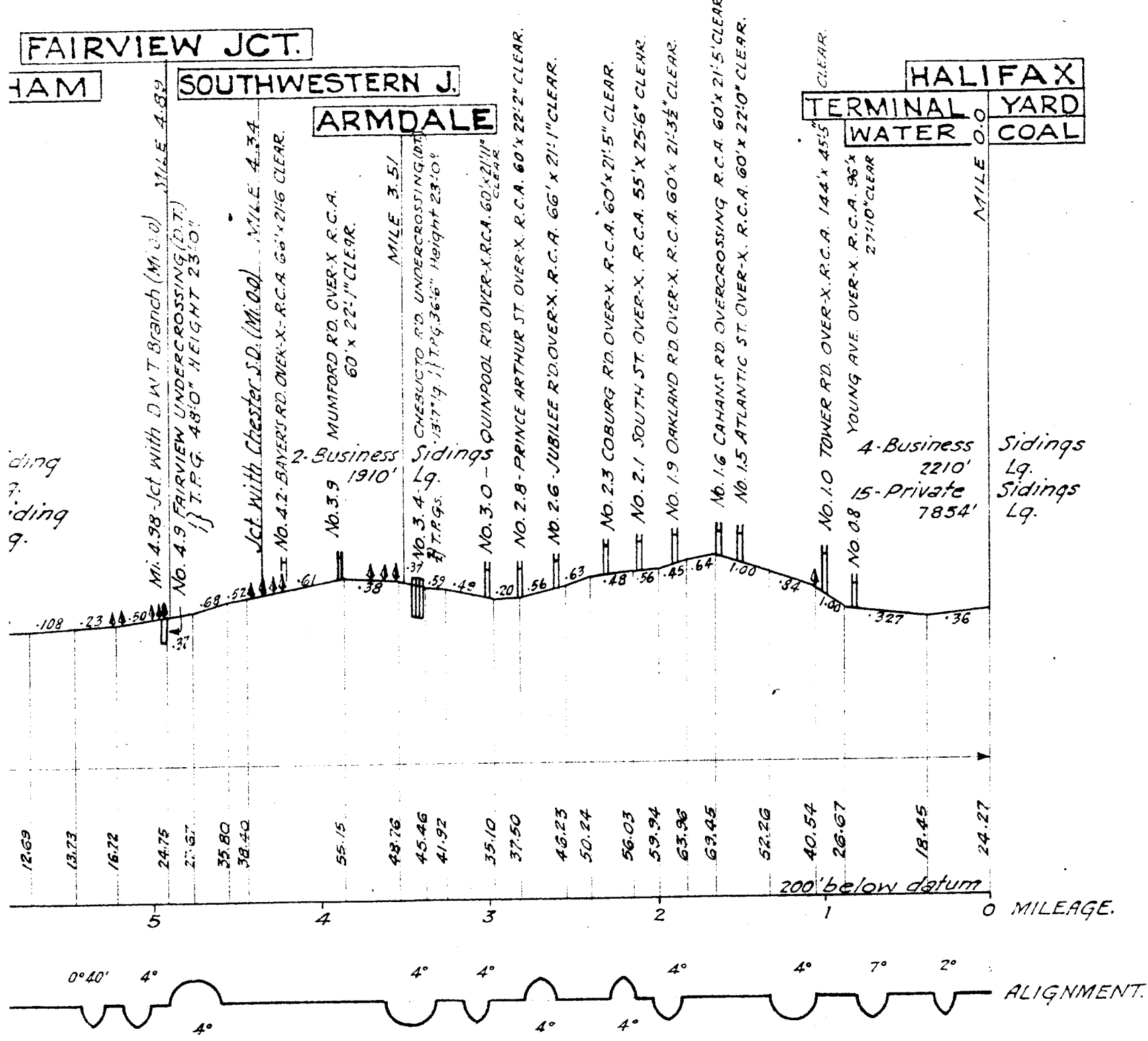

0 MILEAGE.

ALIGNMENT.

AX
ARD
OAL

dings
7.
dings
7.

**CANADIAN NATIONAL RAILWAYS
ATLANTIC REGION**

**HALIFAX DIVISION
BEDFORD DIVISION**

CONDENSED PROFILE

HOR. 1 IN. = 4000 FT.
SCALES.
VERT. 1 IN. = 100 FT.

DATUM - MEAN SEA LEVEL AT HALIFAX

OFFICE OF REGIONAL CHIEF ENGINEER

MONCTON, N.B.
DECEMBER 31-1936.

REGIONAL CHIEF ENGINEER

MILEAGE.

ALIGNMENT.

MADE BY *R.W.L.* CHECKED BY J.F.S.

PLAN NO 17903